

ROYOP

R

Southlands Crossing

2011 Strachan Road SE, Medicine Hat, Alberta

FULLY LEASED



SITE INFO

Southlands Crossing is ideally located in Medicine Hat's strongest shopping node, with easy access from the Trans-Canada Highway. The retail centre features an excellent tenant mix and is shadow-anchored by Walmart and Canadian Tire. Southlands Crossing retailers include Ashley Furniture, PetSmart, Dollar Tree, Starbucks, Dairy Queen, Bulk Barn and more.



LEASING CONTACT

Ben Cowie Leasing Manager

403.618.7753 | bcowie@royop.com

Royop Development Corporation

510 211-11th Avenue SW, Calgary, AB

SITE PLAN AND PHOTOS

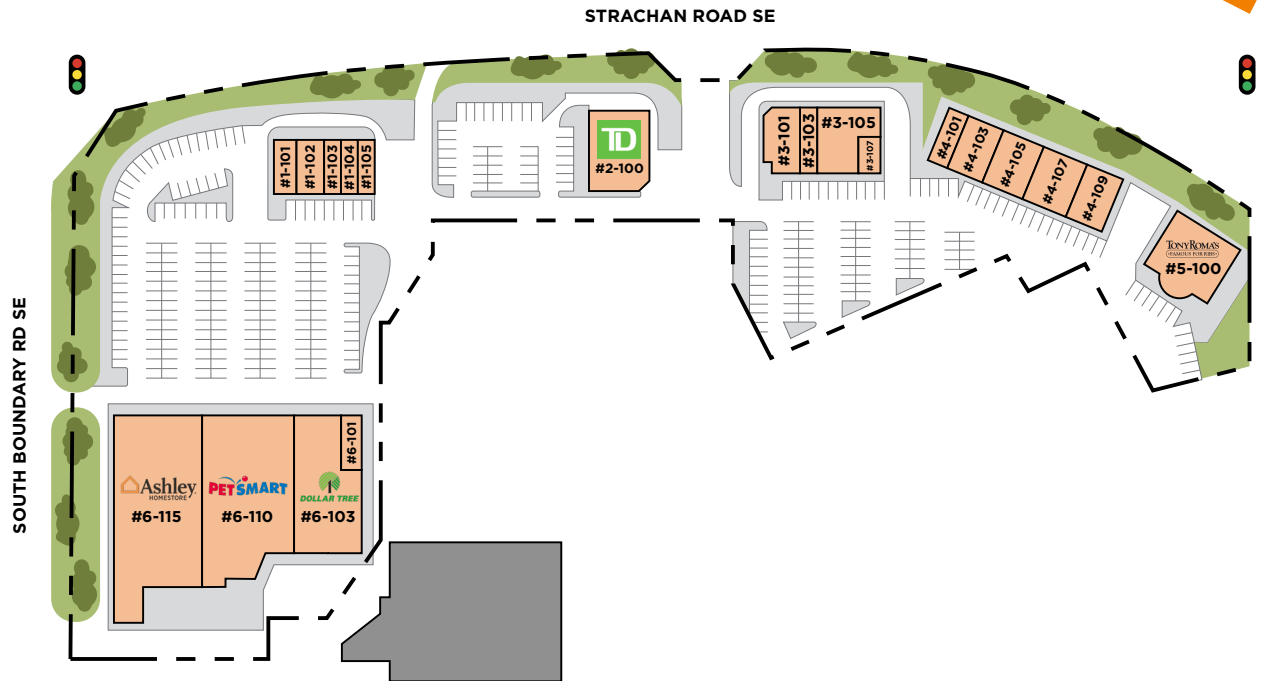

BUILDING 1

- #1-101 Starbucks 1,709 sf
- #1-102 Mucho Burrito 1,762 sf
- #1-103 Polar Nails & Spa 1,183 sf
- #1-104 Subway 1,172 sf
- #1-105 Edo Japan 1,240 sf

BUILDING 3

- #3-101 Dairy Queen 2,952 sf
- #3-103 Specsavers 1,211 sf
- #3-105 Bulk Barn 4,404 sf
- #3-107 Wrights Jewelry 1,010 sf

BUILDING 4

- #4-101 Tommy Guns 1,355 sf
- #4-103 Bob's Liquor 2,520 sf
- #4-105 Warehouse One 3,013 sf
- #4-107 Chatters 3,282 sf
- #4-109 Five Guys Burgers 2,730 sf

BUILDING 6

- #6-101 TELUS/Koodo 1,532 sf
- #6-103 Dollar Giant 9,891 sf
- #6-110 PetSmart 16,813 sf
- #6-115 Ashley Furniture 20,933 sf

PAD SITES

- #2-100 TD Bank 6,200 sf
- #5-100 Tony Roma's 6,139 sf



AREA DEMOGRAPHICS



Population

10th Highest in Alberta

65,949



Income

Average Household Income

\$99,000

Demographics information contained herein was obtained from sources deemed reliable and, while thought to be correct, have not been verified. Royop does not guarantee the accuracy or completeness of the information presented, nor assumes any responsibility or liability for any errors or omissions therein.

ROYOP



Our rich history spans 60 years in Western Canada. Royop is a leader and expert in development and management. Our leasing strategy is proven to retain and attract best-in-class retailers to our centres. We develop and manage mixed use projects.